

Shoulder of Mutton Battery

Commenced	1871	Armament	
Completed	1874: Additions in 1882	1803	5 x 32 pounders.
Cost	£ 4,006	1847	4 x 24 pounders.
Map Reference	TR 324 415	1851	5 x 32 pounders on traversing platforms.
Position	On cliff edge between Dover Castle and Castle Hill	1854	8 x 42pounders
Type	Coast Defence Battery	1870	Recommended 2 x 9 inch RML's and 3 x 7 inch RML's.
Ditch	None	1886	Recommended 2 x 9 inch to be mounted on H. A. (dismounted awaiting carriages)
Guns	5	1887	2 x 9 inch RML's and 3 x 7 inch RMLs
Barrack Accom.	None	1892	2 x 9 inch RML's and 3 x 7 inch RMLs
Present use	Derelict and overgrown	1893	2 x 9 inch RML's and 3 x 7 inch RML's.
History	Coast Defence Battery	1895	3 x 9 inch RML's, 3 x 7 inch RML's and 1 x 6 inch for Drill Only.
Disposal	E.H. ownership	1898	Reductions 2 x 9inch RMLs
Condition	Very overgrown but fair condition	1902	2 x 9inch: reductions 2 x 9inch
Access	None. Can be seen from outside the enclosing fence.	1903	2 x 6 pounder Nordenfelt QF's on R.C.C.
Sources	Coad & Lewis, The Later Fortifications of Dover; Precis of Correspondence Dover to April 1993	1908	Reductions 2 x 6pr QF
		1910	No armament

History and Description

The battery is mentioned in a report of February 1851, with 5 x 32pdrs but was completely reconstructed 1871-74 for RMLs. In 1870 the Defence Committee recommended that two 9-inch RMLs be mounted at Shoulder of Mutton Battery and in 1872 the Committee agreed that three 7-inch 7-ton RMLs should be mounted as well.

The battery was constructed as a line of five emplacements with the extreme right hand emplacement (east) isolated from the rest by a rock outcrop. The left (west) three were for 7inch RML guns mounted on D pivot dwarf carriages. The two east emplacements in the line were for 9-inch RMLs on a C pivot dwarf pattern platforms. Behind and adjacent to the line of emplacements were the expense cartridge and shell stores some of which were later re-appropriated as a coal and oil store, reception magazine, explosive magazine and tool store. On site by 1882 was a laboratory and a proof house.

In 1886 the Royal Artillery and Royal Engineers Works Committee recommended that the two 9-inch RMLs should be adapted for high-angle fire, and a table of armaments in 1887 showed high-angle mountings approved. An 1892 table of armaments shows the two 9-inch RMLs as being "*For long range*" but in 1893 the long-range mountings were still awaited and a note reads "*No provision yet made for works.*" The Works Committee reported in 1893 that a new cartridge store was under construction. By this time the battery was, at best, obsolescent and all the Dover RML batteries were rendered obsolete and unnecessary by the BL batteries built at the Citadel and Langdon Cliffs at the turn of the century. In 1902 it was proposed to mount two 6pr QF guns in emplacements 2 and 3 for defence of the inner harbour. By 1903 this was done. There were withdrawn in 1908. A tunnel was constructed to connect the main battery with the extreme east gun emplacement.

When visited in 1996 and again in 2005 the battery was overgrown and derelict but in quite good condition. The tunnel to the number 5 emplacement was sealed but the emplacement can be viewed from the path The battery is outside the Castle's perimeter but behind a fence.

Shoulder of Mutton Battery

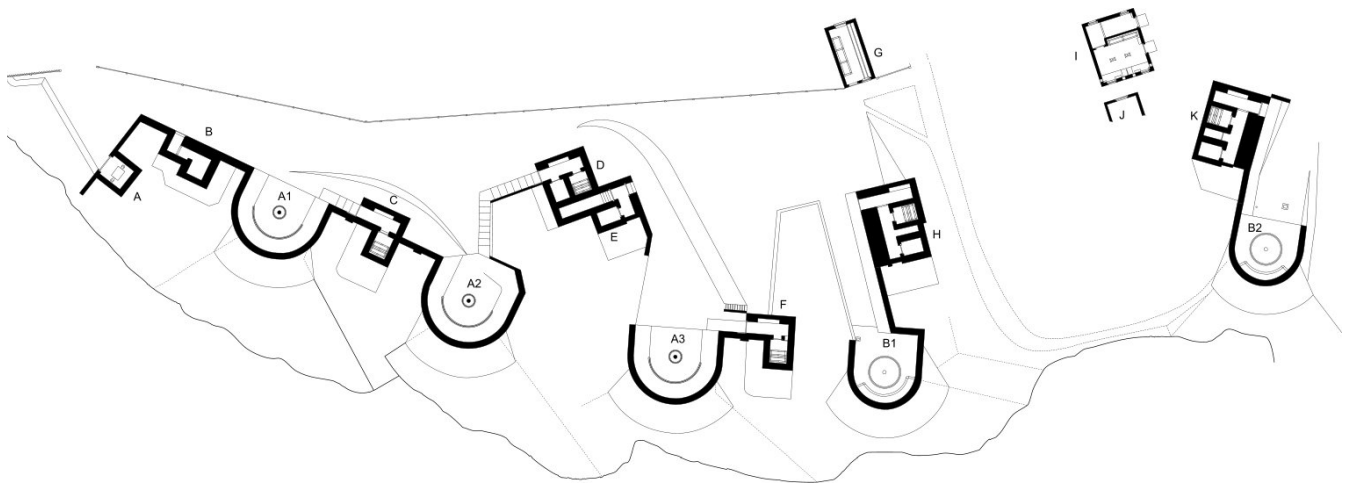

A1 - A3 7inch RML

B1 - B2 9inch RML

A Gas meter

B Shell Store

C Cartridge Store

D Shell & Cartridge Store

E Shell Store

F Cartridge store

G Proof House

H Shell & Cartridge Store

I Laboratory

J Shell & Cartridge Store

